

# TOWNHOUSE SPECIFICATIONS



Open plan living, a delight for entertaining



A full size kitchen with quality appliances



Sleep sound in your spacious bedroom



Fresh modern en-suite bathroom to pamper and relax in

## Features

- Architecturally designed
- 2 large bedrooms
- 1.5 bathrooms
- Call alarm system
- LED lighting
- Double glazing
- Heat pumps
- Carpet and vinyl floor coverings
- Wider doors and hallways to allow for
- Wheelchair and walkers
- Level entranceways
- Single storey (no stairs)
- High speed internet connection

## Kitchen

- Fisher & Paykel wall Oven
- Fisher & Paykel Fridge/Freezer
- Fisher & Paykel dishwasher
- Panasonic Microwave
- Ceramic cooktop and rangehood
- 30mm Quartz bench tops
- Tiled splash backs
- Low shallow cupboards for easy access

## Bedroom

- Built-in wardrobe organisers

## Laundry

- Laundry tub
- Laundry dryer vent
- Fisher & Paykel washing machine
- Fisher & Paykel dryer

## Bathroom

- Grab rails in shower and toilet
- Pull down Shower seat
- Tiled showers with frameless glass
- Slip resistant tiles
- Heated towel rail
- Wall-mounted storage cupboard
- Wall-mounted vanity with mirror and splashback

## Exterior

- Internal access garage with remote door opener
- Foldaway clothes line
- Letterbox
- Exterior hose tap
- Planted garden
- Automatic irrigation
- Outdoor patio area

You would supply your own, Freeview or sky decoder, telephone and internet modem



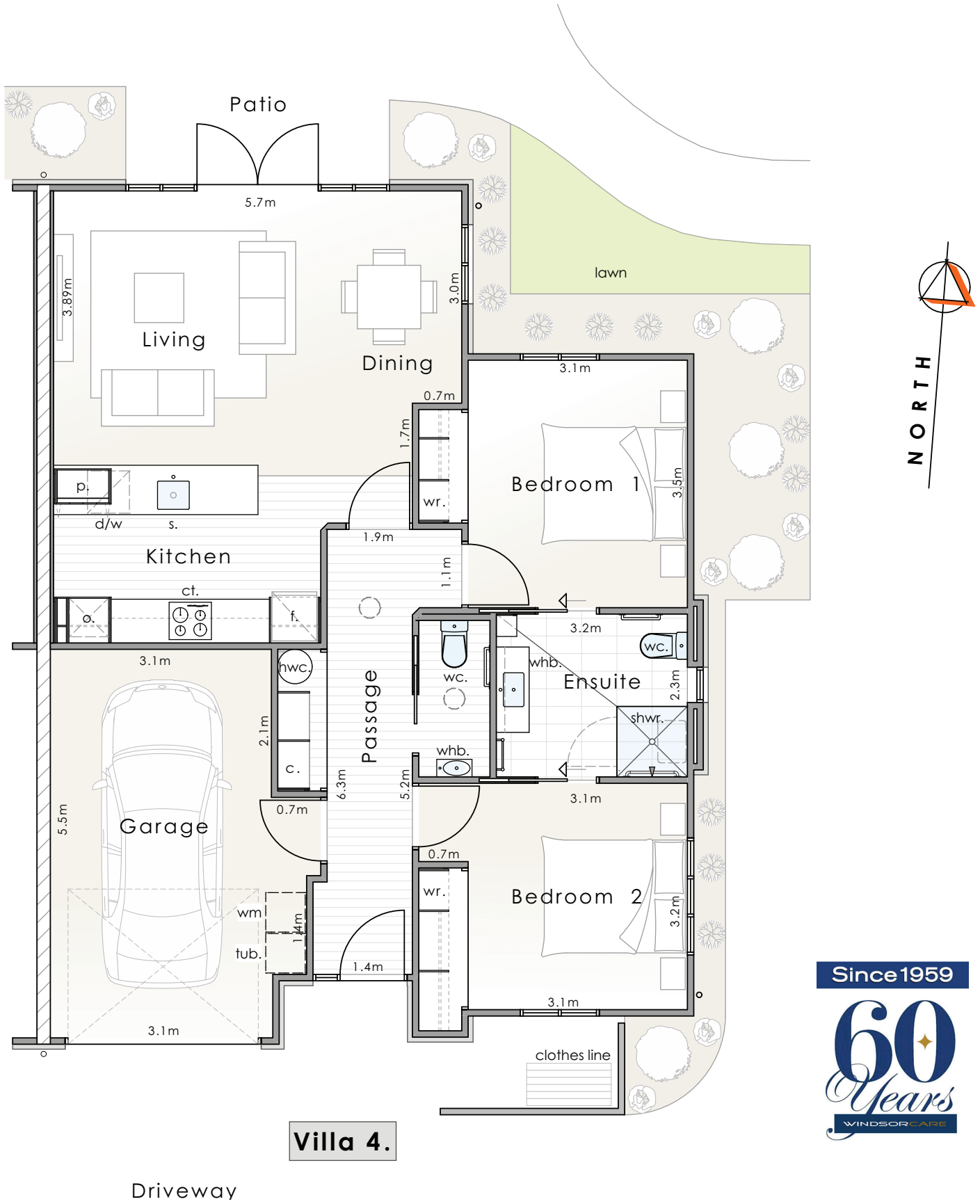

**Villa 4.**

Driveway

